

REV	LOCATIONS	DESCRIPTION	DATE	REVISER	APPD
1	▲	Flame Rating update	19/DEC/23	MATT	LEO

Electrical
 Current Rating: 5A AC(rms)/DC
 Voltage Rating: 250V AC(rms)/DC
 Contact Resistance: 20 mΩ Max
 Insulation Resistance: 1000 MΩ MIN
 Withstanding Voltage: 1500V AC r.m.s
 Temperature Range—Operating: -25°C~+85°C
 Material and Plating
 Housing: PA66(UL 94V-2) ▲
 Contact Pin: Brass
 Plating: Tin Plated

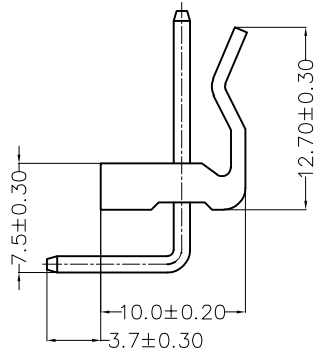

Circuits (n)	Part No.	DiSensions(mm)	
		A	B
2	FWF50806-S02B22TB	5.08	10.16
3	FWF50806-S03B22TB	10.16	15.24
4	FWF50806-S04B22TB	15.24	20.32
5	FWF50806-S05B22TB	20.32	25.40
6	FWF50806-S06B22TB	25.40	30.48
7	FWF50806-S07B22TB	30.48	35.56
8	FWF50806-S08B22TB	35.56	40.64
9	FWF50806-S09B22TB	40.64	45.72
10	FWF50806-S10B22TB	45.72	50.80
11	FWF50806-S11B22TB	50.80	55.88
12	FWF50806-S12B22TB	55.88	60.96

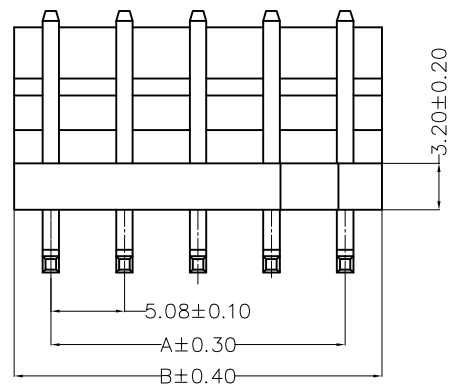
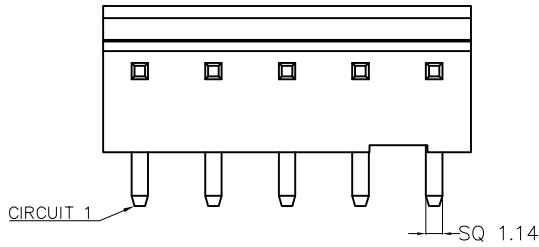
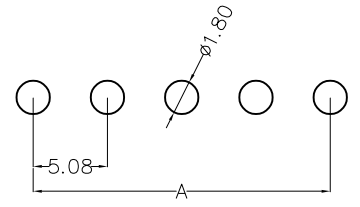

Recommended P.C.Board Layout

<p>THIRD ANGLE PROJECTION</p>	GENERAL TOLERANCES (UNLESS SPECIFIED)		APPROVE BY LEO	DATE 30/JAN/23	PART NO. FWF50806-SXXB22TB	ITEM NO. FWF50806	<p>Building Technology Cornerstone</p>	
	X. ±0.30	X.' ±5'	CHECKED BY GISELLE	DATE 30/JAN/23	TITLE Wire to Board (Wafer) Pitch 5.08mm 90° Angle (DIP)			REV 1
	DESIGN UNITS METRIC(mm)	X.X ±0.20	X.X' ±2'	DRAWN BY MATT	DATE 30/JAN/23	THIS DRAWING CONTAINS INFORMATION THAT IS PROPRIETARY TO TXGA INDUSTRIAL ELECTRONICS(S.Z)CO.,LTD AND SHOULD NOT BE USED WITHOUT WRITTEN PERMISSION		SHEET NO. 1/1
	SCALE 5:1	SIZE A4	X.XX ±0.15	X.XX' ±1'				